

General description

The loft has a spacious, contemporary feel.

Immediately upon entering, the living area is to the left and the open kitchen is to the right. A dining table is directly in front, and a second room (Blair's room) is walled off behind the table. The living area has a high ceiling and appears to be corrugated metal; the "loft" is Jim's bedroom and is directly above Blair's bedroom. A short hallway continues past Blair's room on one side and the kitchen on the other to reach a back entrance and the bathroom.

In early episodes, the loft was sparsely furnished and all of the walls were white (compare Cypher 1.05 to Warriors 3.01). Between first and second seasons, the production team tired of shooting against a white background, and the loft was painted. At least two of the walls are dark brick and are presumably outer walls since they contain windows. The wall that contains the main entrance is painted (white in early episodes, dark colors in later episodes), and appears to be plaster or drywall.

Most of the natural light enters from the three large balcony doors. The ceiling over the kitchen is cut into the interior, creating a slanted skylight and a vertical section of wall (easily seen in the episode "Cypher" 1.05). There skylight is a row of six frosted-glas panes with a very industrial feel (like something from a factory) The vertical section of wall above it has three four-paned windows. The main room has three windows near the ceiling in the brick wall that has the staircase to Jim's room, and Blair's room appears to have at least one small window in that same brick wall, indicating that it must be an outer wall. His room also has two windows in the walls that divide it from the rest of the loft: one looks into the main room (a lamp in Blair's room is often seen in scenes shot in the living area) and the other looks into the hallway, across from the bathroom. There seem to be no windows in Jim's room, but sometimes it is possible to see the four-paned windows above the kitchen skylights.

There is usually little clutter, but in the episode "The Rig" (2.08) Jim complains about Blair's clutter in the living area and tells him he must keep all of his belongings in his room.

Furnishings are modern/contemporary, and seem to favor light wood and metal. Think Crate & Barrel meets Pottery Barn with a little Pier 1.

While the floor plans given at the end of this document were derived from the episodes aired to date, a few of the details came from reports and pictures from those who have visited the set. Most of these non-episode details concern Blair's bedroom, a room that has rarely been seen in detail in the show. I am indebted to those who have shared their experiences, as well as to those who have given me feedback and spent hours with the freeze-frame. I hope this document is entertaining and useful.

As always, if you have any comments, corrections, suggestions, or rants, feel free to contact me at chaomath@mcs.net.

Chaomath

Outside the loft

Street address is 852 Prospect, Cascade, WA. The loft is unit 307 according to the number on the door.

An exterior shot seems to indicate that the loft is on the third floor (top) of a building that has businesses at street level. However, the exterior shot doesn't match the known pattern of windows given from interior loft shots. There is an exterior fire escape.

The first floor of the building is a store with a red awning and the name "Colette's" in script.

The street entrance is located immediately to the left of Colette's.

Jim purchased the loft with a \$50,000 settlement from the Army (Covert Ops) for back-pay during his time in Peru. He had rented it prior to this.

A small metered parking lot (no curbs) is in front of the building.

The wall directly opposite the main entrance to the loft is white, and a glass-boxed fire extinguisher is clearly visible. There are several large pipes in the corners. The hallway dead-ends at the entrance to the loft; a small window is visible on the dead-end wall.

The hallway is long and straight, with one door to another unit in the building and one door marked EXIT (presumably leading to a stairwell).

The elevator is at the end of the hallway. The elevator door is light blue and has a round window.

Two metal industrial lights (similar to those inside the loft) hang from the ceiling.

Second Chance (2.10)

Spare Parts (2.09), Warriors (3.01), Second Chance (2.10)

Hear No Evil (2.13)

Deep Water (2.03)

The Girl Next Door (3.03)

Iceman (2.07), Cypher (1.05), Vendetta (3.06)

Love Kills (3.18)

Love Kills (3.18)

Vendetta (3.06)

Living Room

Hardwood floors throughout the main floor.	Iceman (2.07)
In early episodes, the walls in the loft are distressed white. Later episodes have two of the brick walls in the living area painted and distressed; dark greens and reds.	
In early episodes, the main door was simply painted like the brick walls. Later, a large graphic poster for Red Heron fish hooks (Buck's Bait Shop) appeared on the inside of the door.	
Industrial-style metal hanging lamp directly above the door.	True Crime (2.06)
Balcony doors: 3, 6-paned doors with yellow or white paper shades. The shades have a simple bamboo pattern.	Warriors (3.01), Deep Water (2.03)
Windows: three nearly-square windows high in the brick wall above the stereo (matching the windows above the kitchen). Early morning light comes strongly in these windows, so they may face East.	True Crime (2.06)
Small, wooden chair next to small table by the door to the loft.	Warriors (3.01)
Woodburning stove in corner.	Iceman (2.07)
Lamp over dining table mounted on loft.	Sleeping Beauty (2.24)
Metal coat rack on wall, immediately to the right upon entering through the main door.	
Large sofa and loveseat in a light gray or white substantial fabric.	Iceman (2.07)
Large geometric-print, dark colored accent cushions.	Iceman (2.07)
Shelves at foot of stairs, along brick wall, with 3 tall panels (paintings) above.	Warriors (3.01)
Stereo system at foot of stairs on shelves: has a remote control.	Sweet Science (3.16)
Stereo speaker on floor in corner by balcony doors.	Iceman (2.07)
Large plant (tree) in corner by balcony doors.	Warriors (3.01)
Rug: rectangle covers floor and follows length of both couches, divided into 4 triangles: red, blue, yellow, white.	Iceman (2.07), Sleeping Beauty (2.24)
Light yellow leather armchair at end of balcony doors.	Spare Parts (2.09)
Light hanging from ceiling over leather armchair.	Warriors (3.01)
Bicycle hangs on pillar next to stairs (formerly by kitchen island).	Hear No Evil (2.13)
Metal door (painted) under stairs.	Private Eyes (2.19)
Circuit box and switches to the left of the door under the stairs.	Private Eyes (2.19)

Living Room

Tables

Dining table is located directly in front of entrance to Blair's room. It is metal (brushed aluminum or steel), has 6 wooden chairs, and is glass-topped. Usually has little clutter .

Spare Parts (2.09), Warriors (3.01)

Low, square table where couches meet. Holds table lamp with square shade and black cordless phone.

Warriors (3.01)

Low, square wheeled table with TV and VCR.

Warriors (3.01)

Low, rectangular coffee table.

Warriors (3.01)

Low, narrow box/chest behind loveseat with piles of books, magazines.

Blind Man's Bluff (2.12)

Low table to immediate left upon entering the loft. Holds small lamp and basket for keys and papers.

Warriors (3.01)

Kitchen

Open to living room, located just to the right of Blair's room.	Spare Parts (2.09)
White kitchen appliances.	Spare Parts (2.09)
Light-colored wood-faced cabinets.	Spare Parts (2.09)
In early episodes, the kitchen walls are white. Later, the wall above the sink is dark green (to match the rest of the loft).	
Large, round ventilating fan in wall at back of kitchen, above refrigerator, possibly connecting to bathroom.	Warriors (3.01)
Island: contains cooktop, wooden paneling below, and books at end of island that faces living room. In some episodes (Secret 2.15, His Brother's Keeper 2.23), the island has two stools.	Warriors (3.01), Hear No Evil (2.13)
Pots hang from ceiling above the island.	Hear No Evil (2.13), True Crime (2.06)
White phone on pillar next to refrigerator.	Warriors (3.01)
Microwave on top of refrigerator in some episodes (though it is missing in other episodes).	Warriors (3.01)
Lighting	
Skylights on an angle run the length of the kitchen: paneled with frosted glass (6 sections).	Warriors (3.01), Cypher (1.05), Hear No Evil (2.13)
Three large, 4-paned windows on the vertical section of wall above the angled section that contains the skylights. Also visible from Jim's room in some episodes.	Hear No Evil (2.13), Cypher (1.05), His Brother's Keeper (2.23)
Two industrial lights hang from the ceiling.	His Brother's Keeper (2.23)

Jim's Bedroom

Located upstairs, open to living room (i.e., a true loft).	
Stairs along the brick wall opposite the main entrance lead to the loft.	Warriors (3.01)
Railing (blue-green pipe) for stairs runs along the brick wall. This railing continues around the loft platform.	Warriors (3.01), Spare Parts (2.09)
Small wooden nightstand between bed and stair railing.	Spare Parts (2.09), True Crime (2.06)
Queensize (at least) bed, with head against railing overlooking living room.	Spare Parts (2.09), True Crime (2.06)
Blue sheets, pillowcases, yellow-on-yellow (striped) comforter and pillowcases. In True Crime, Jim sleeps with his automatic beneath his pillow.	Warriors (3.01), Love Kills (3.18), Hear No Evil (2.13), True Crime (2.06)
Desk next to bed with black swing-arm lamp and computer.	Iceman (2.07)
Door along back wall, dark paint.	Iceman (2.07)
Two wall sconces on back wall, with dresser in between.	Iceman (2.07)
Tall set of open wire metal shelves along wall at top of stairs.	Iceman (2.07)
Windows over the kitchen are visible.	Hear No Evil (2.13)
Ceiling appears blue corrugated metal.	Flight (2.01)

Blair's Bedroom

Located on main floor just off living room. It is an oddly-shaped room (i.e., not rectangular).	
Both of the two walls that separate the room from the rest of the main floor have windows. One window looks into the main living area, the other window looks into the hallway.	
Blair keeps pictures along the windowsill of the window that looks into the main room.	Cypher (1.05)
Door (first season): curtain. Door (second season): glass-paned french doors with curtain across the glass.	
Red rug (Navajo?) hangs over desk.	Spare Parts (2.09), Sleeping Beauty (2.24)
Door on same wall as door at end of hallway. Upper portion is frosted glass. It connects outside; the view shows a brick wall and iron railings, possibly a fire escape.	Secret (2.15), Sleeping Beauty (2.24)
Many pillows on Blair's bed, in multiple prints.	Sleeping Beauty (2.24)
Quilt is dark and richly patterned.	Sleeping Beauty (2.24)

Bathroom

Located on main floor on the opposite side of the hall from Blair's bedroom (thus on same side of the hall as the kitchen), next to the back exit.

It is assumed that there is no other bathroom because Jim uses this one. Warriors (3.01)

Hallway

Wide metal door at end of hallway. Warriors (3.01), Love Kills (3.18), Cypher (1.05)

Low-intensity, square lights flush with ceiling—under loft overhang, too. Warriors (3.01)

Balcony

Large potted plants. Warriors (3.01)

One white patio chair (plastic?). Warriors (3.01)

Possibly facing East, as sun shines brightly in during early morning. True Crime (2.06), Sleeping Beauty (2.24)

The Loft

21.04.98
©1998 by Chaomath
Nolly Publishing

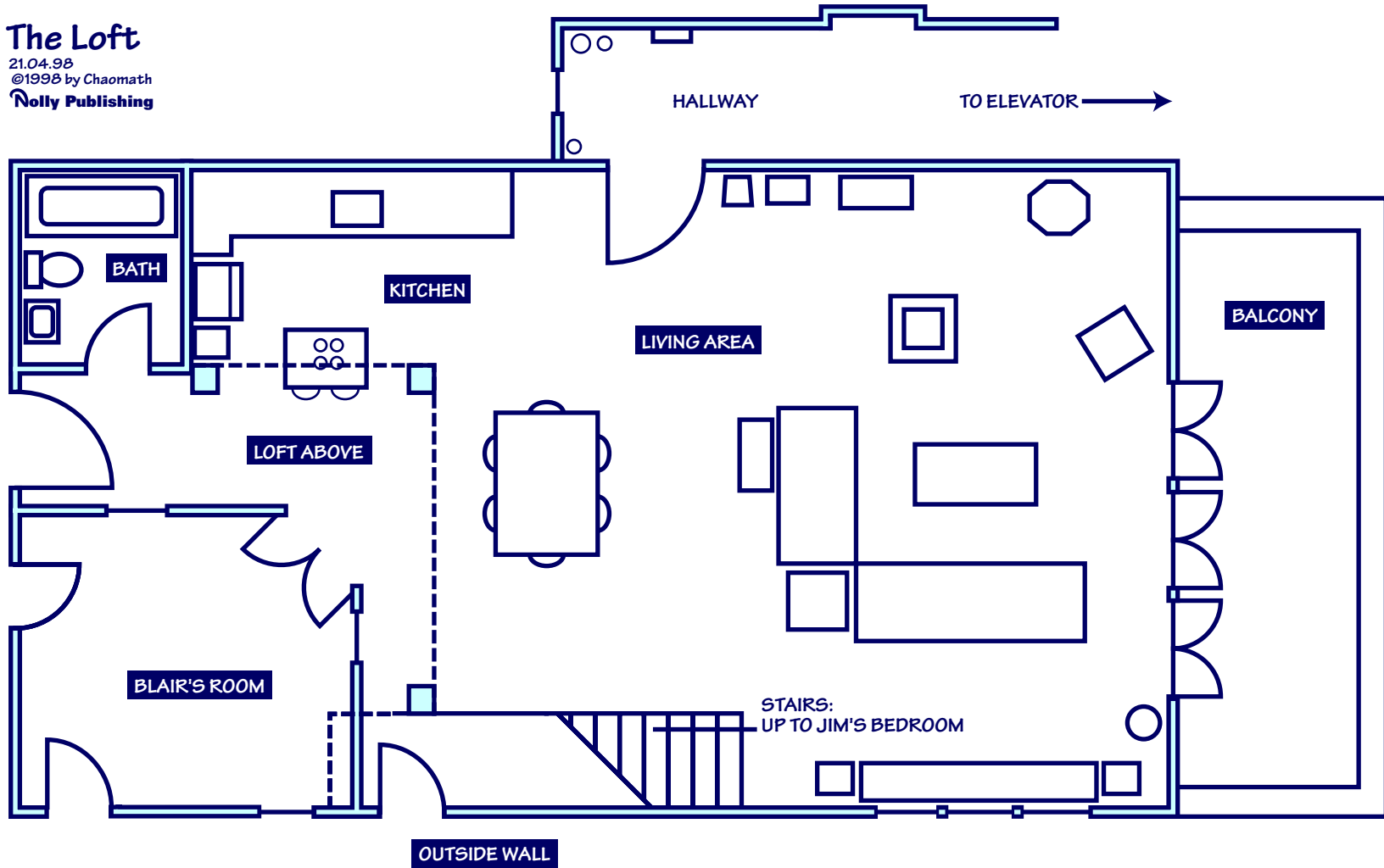

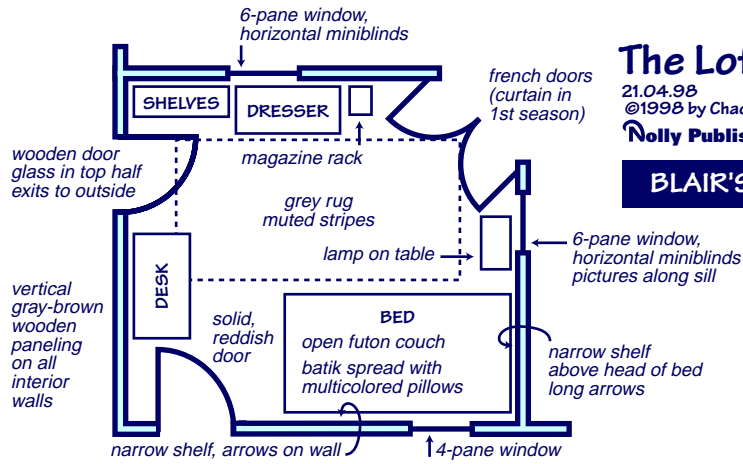

The Loft

21.04.98
©1998 by Chaomath

Nolly Publishing

BLAIR'S ROOM

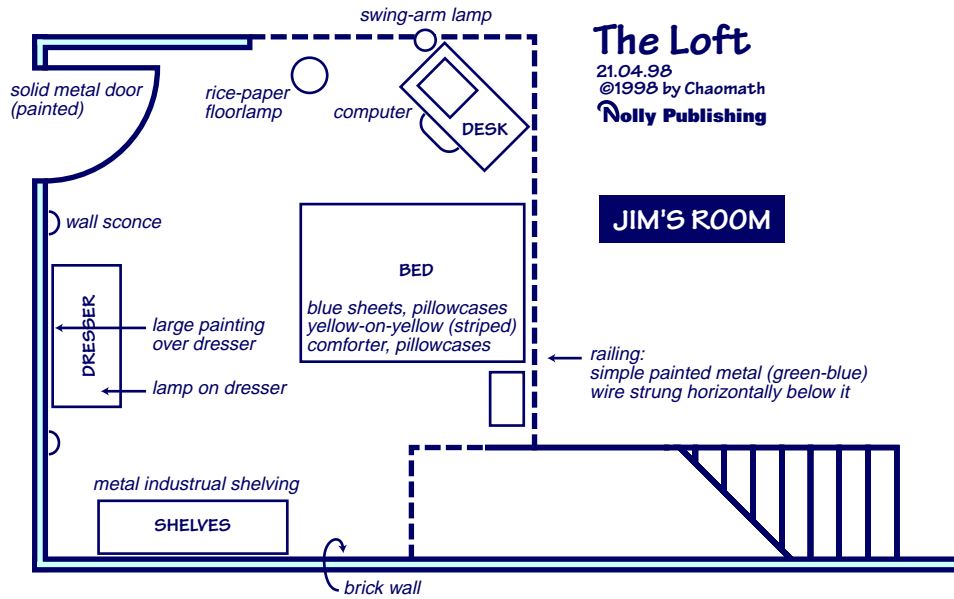

The Loft

21.04.98
©1998 by Chaomath

Nolly Publishing

JIM'S ROOM